

Site Amenities

BY SUPERIOR RECREATIONAL PRODUCTS



Model #
LG_SURF_CVR-SGL_SET

HARDWARE AND TOOLS REQUIRED

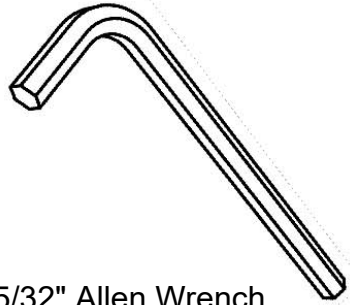

5/32" Allen Wrench



1/4-20 x 1" Button
Head Cap Screw

PRODUCT SPECIFICATIONS

Cover Plates are made from cast aluminum.

Hardware: All Hardware shall be zinc coated.

Dimensions: Center opening shall be 2-15/16", overall height shall be 2", and overall diameter shall be 8".

COMPONENTS

Attach the two cover plate halves together using the specified hardware.

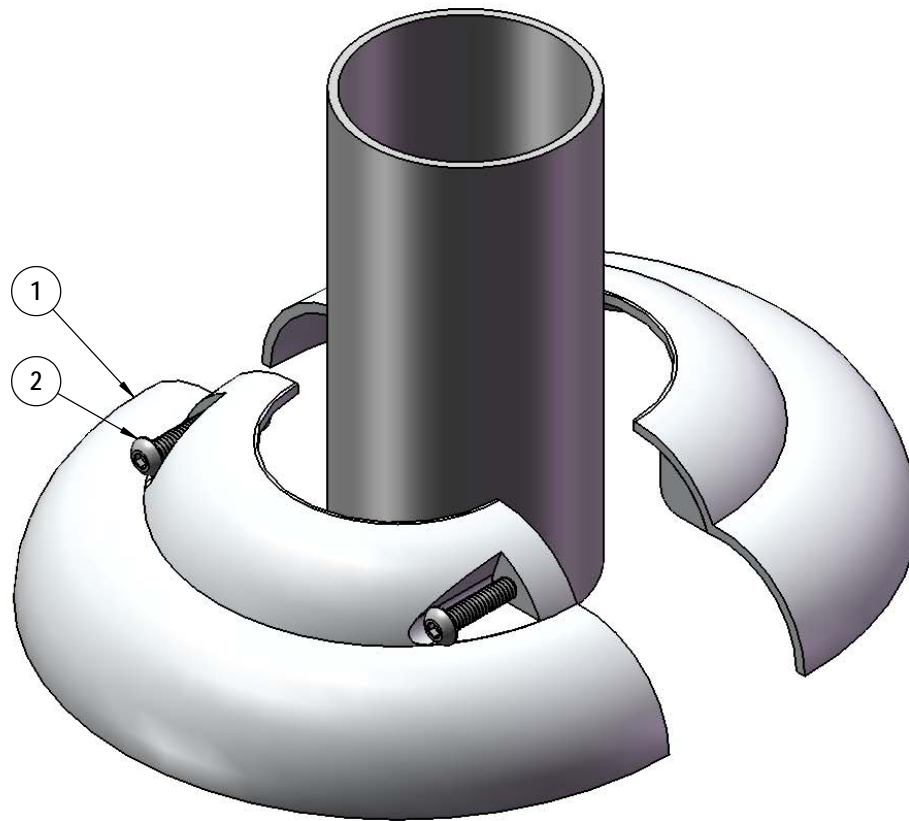

ITEM NO.	PartNo	DESCRIPTION	Qty.
1	P-01-01-0162	Cover Plate-2 7/8"	1
2		1/4-20 x 1" Button Head Cap Screw	2